

Lift Switch Installation

JD 7000 / Kinze Regular Parallel Arms
726265

The final step of the Air Force installation is the Lift Switch. The Lift Switch will be located on the lower parallel arm of any row unit **that has** a Row Unit Module **but does not have** a Vacuum Sensor.



As a reminder, below are pictures of the Row Unit Module alone and shown as installed.

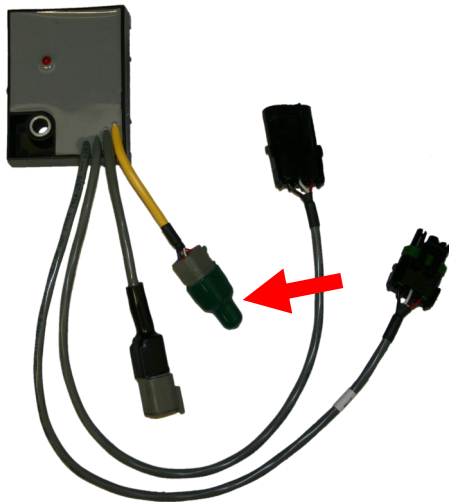

The Lift Switch has a 6-pin female receptacle that connects with the corresponding 6-pin Auxiliary male plug (shown above with yellow cable and green dust cap)

Lift Switch Installation

JD 7000 / Kinze
726265

Regular Parallel Arms
(Continued)

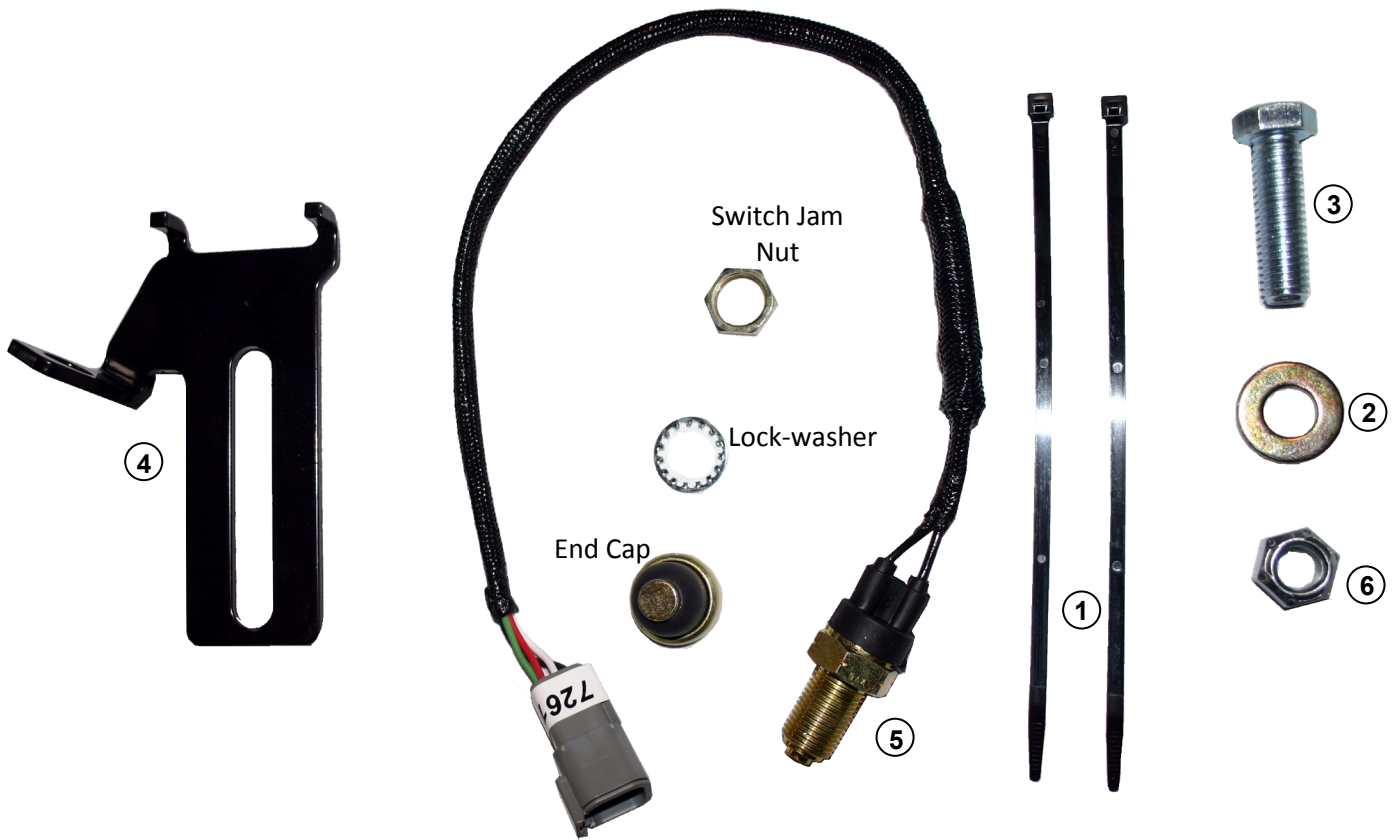

Item	Quantity	Part Number	Part Name	Description
1	2	63126	Cable Tie	8" UV Black
2	1	33086	Washer	1/2" SAE Flat YLW ZN
3	1	13210	Bolt	1/2"X1.75 GRD 5
4	1	726257	Bracket	
5	1	726608	Switch	
6	1	37268	Lock Nut	1/2" SAE Top GRD C



Install the nut and lock-washer on the threaded Switch Shaft and thread to the base. Insert the Switch through the hole in the provided bracket as shown at left.

Lock-washer
Separated for viewing, install along with nut prior to placement in bracket hole.

Lift Switch Installation

JD 7000 / Kinze
726265

Regular Parallel Arms
(Continued)

Once the Switch shaft is in place through the hole thread the End Cap fully onto shaft until finger tight. Fix in place by tightening the Nut/Lock-washer against the bracket using a wrench. Completed assembly shown at right.



On a row unit with a R.U.M. and without a Vacuum/Pressure sensor install the assembled Bracket/Switch onto the lower left hand parallel arm. Align the assembly with the rear most hole in the parallel arms and hold in place using the provided 1/2" X 1.75 bolt, flat washer and hex nut. **Do not** fully tighten the assembly until you have properly positioned the Switch.

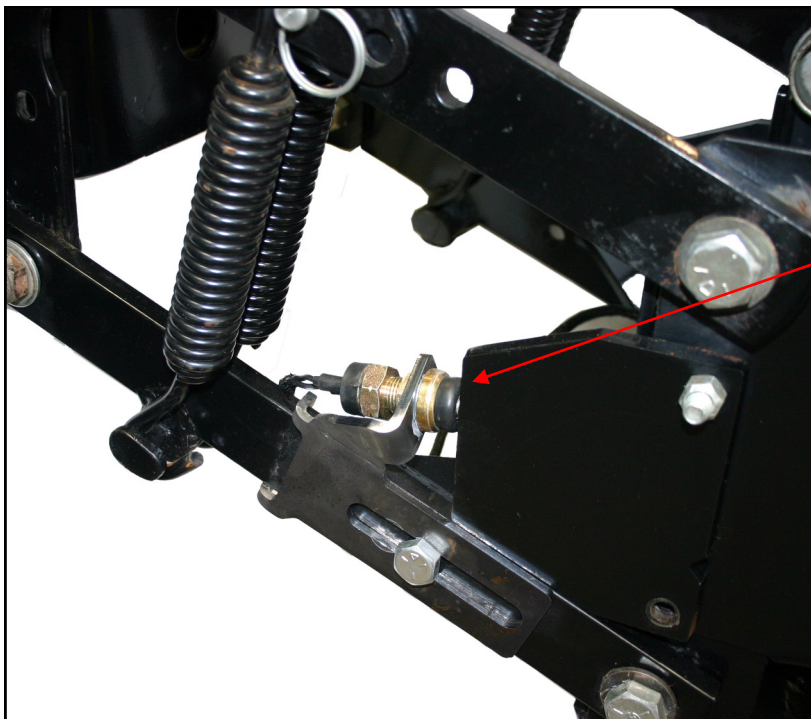

The correct positioning of the Switch may be found with a raised planter by pushing against the assembly towards the rear of the row unit to depress the End Cap. Once the assembly has been properly positioned as shown at left, fix in place by tightening down the 1/2" Bolt.



Complete the installation by connecting the 6-Pin connector into the auxiliary port of R.U.M.