

Lift Switch Installation

White
726655

The Lift Switch will be located on the lower parallel arm of any row unit **that has** a Row Unit Module **but does not have** a Pressure Sensor.

As a reminder, below are pictures of the Row Unit Module alone and shown as installed.

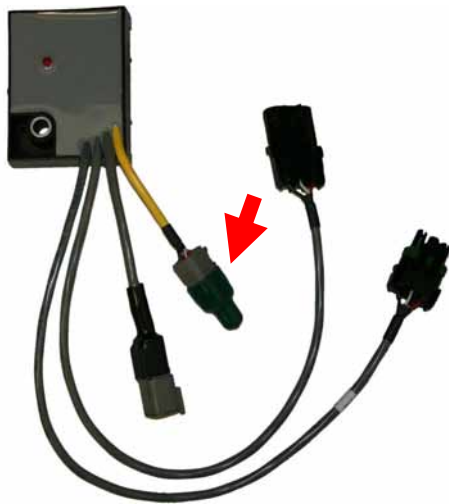

The Lift Switch has a 6-pin female receptacle that connects with the corresponding 6-pin Auxiliary male plug (shown at left with yellow cable and green dust cap)

White 8000



White 5000 / 6000



White Lift Switch Installation

726655 (Continued)

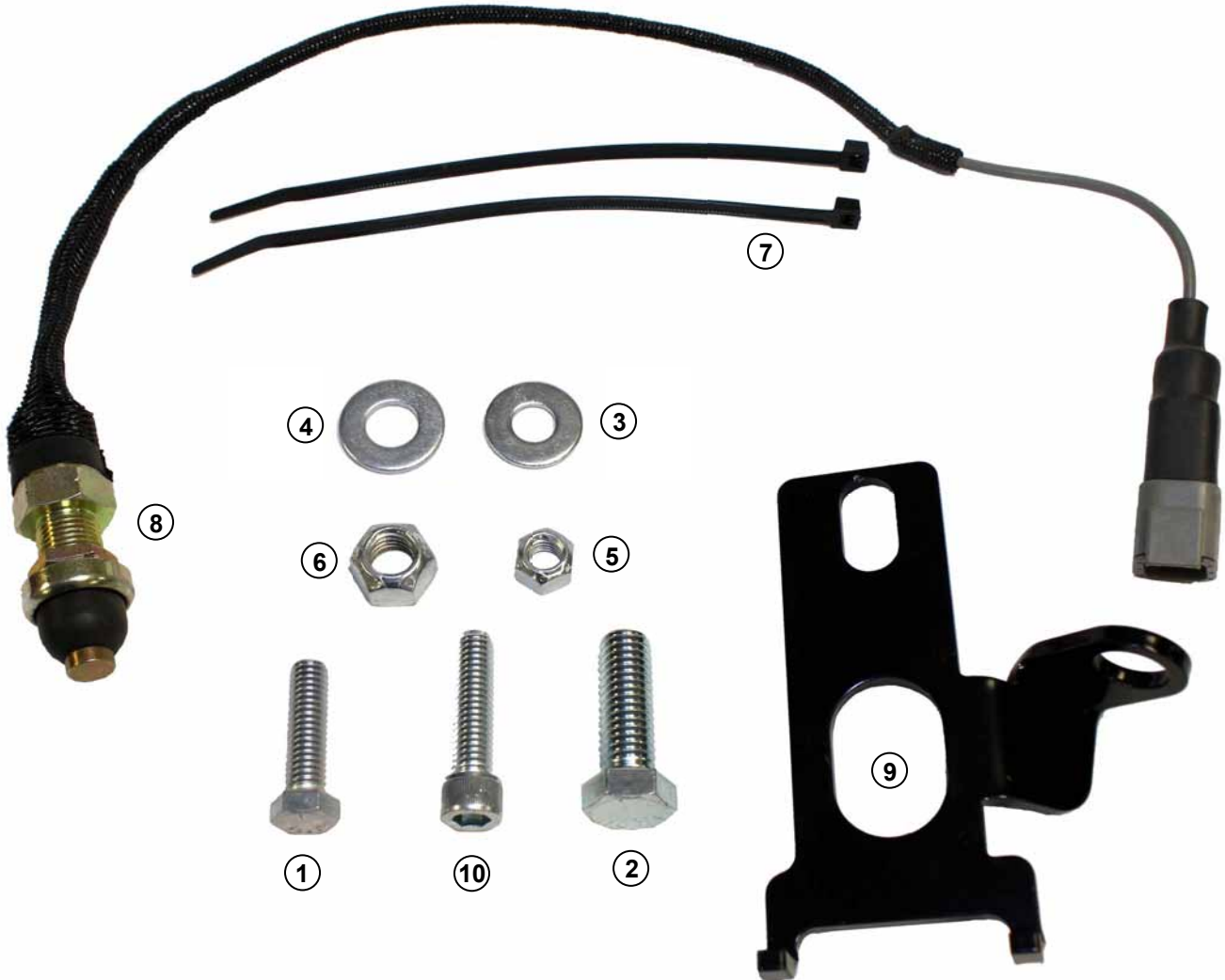

Item	Quantity	Part Number	Part Name	Description
1	2	13108	Bolt	3/8" X 1.375 GRD5 Bolt ZN
2	1	13209	Bolt	1/2" X 1.5" GRD5 Bolt ZN
3	8	33008	Washer	3/8" USS Flat ZN
4	1	33086	Washer	1/2" SAE Flat ZN
5	2	37264	Hex Nut	3/8" Top Lock Nut ZN
6	1	37268	Hex Nut	1/2" Top Lock Nut ZN
7	2	63126	Cable Tie	8" UV Black
8	1	726608	Switch	Lift Switch
9	1	726692	Bracket	White Lift Switch Bracket
10	1	24637Z	Low Head Bolt	3/8" X 1.5" Bolt ZN

Note: Not all components will be used in all installations.

White Lift Switch Installation

726655 (Continued)

Install the nut and lock-washer on the threaded Switch Shaft and thread to the base. Insert the Switch through the hole in the provided bracket as shown at left.

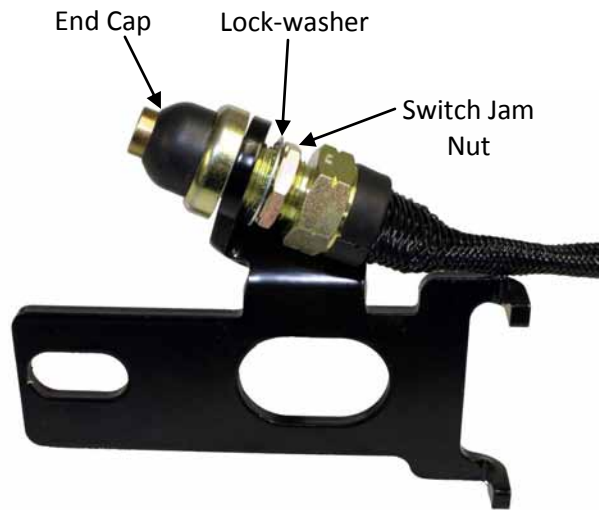

Once the Switch shaft is in place through the hole thread the End Cap fully onto shaft until finger tight. Fix in place by tightening the Nut/Lock-washer against the bracket using a wrench. Completed assembly shown at right.



White Lift Switch Installation

726655 (Continued)

Use Cable Ties as necessary to secure and safely route wire harness.

For systems without Lift airsprings installed, use the standard 3/8" X 1.375" GRD5 bolt (13108) in this location.

For systems with Lift airsprings installed, use the provided 3/8" X 1.5" GRD5 Low Head Bolt to allow for clearance around the Lift Air Bag

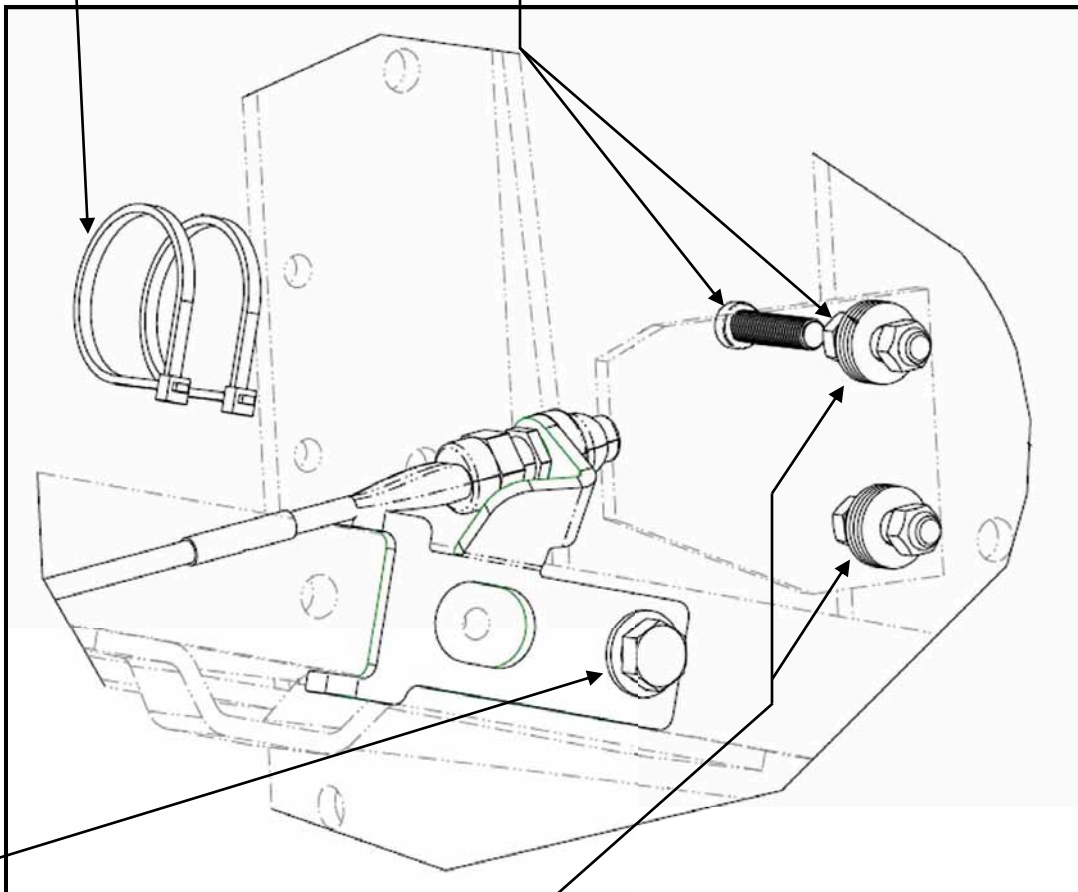

For systems without Lift airsprings installed, use the 1/2" X 1.5" Bolt provided with this lift switch kit.

For systems with Down and Lift airsprings installed, use the 1/2" X 2.75" Bolt provided with the Lift AirForce kit.

Install washers between the row unit frame and the stop plate, **as needed**, to ensure that the lift switch plunger (end cap) makes solid contact with the stop plate.

White Lift Switch Installation

726655 (Continued)

The correct positioning of the Switch may be found with a raised planter by pushing against the assembly towards the row unit to depress the End Cap. Once the assembly has been properly positioned as shown at right, fix in place by tightening down the 1/2" Bolt.

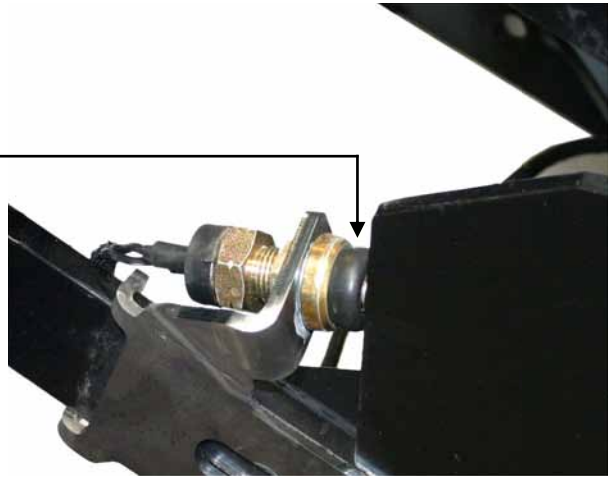

Complete the installation by connecting the 6-Pin connector into the auxiliary port of R.U.M.

