

Row Unit Conversion Instructions

for:

planter models:White 5000/6000/8000

to convert from **Existing Springs:**.....White Adj. Center Springs,
(Center Quad)

to **Resulting Forces Controlled:**.....Down and Lift

with **Conversion Kit:**.....726640

Existing Springs

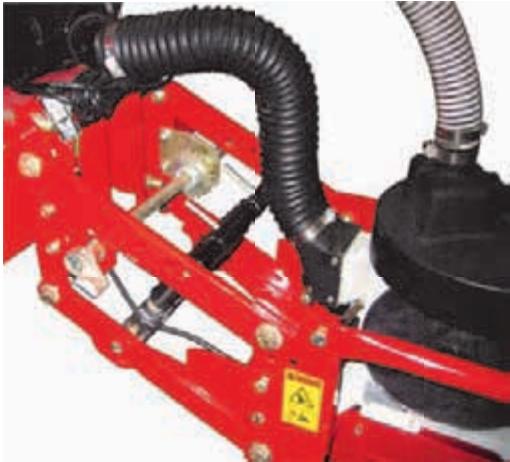

This conversion process applies to White planters with Spring or Pneumatic down force systems. The examples shown are generalizations for illustrative purposes; some components shown here may not apply to your particular planter. Special notes will be made throughout the following instructions to encompass individual model needs as necessary. Images illustrating a completed row unit conversion are located at the end of these instructions.

Conversion Kit Components

ITEM	QTY	PART NUMBER	PART NAME	DESCRIPTION
1	1	726101	Spring	Air Bag (Lift)
	1	726646	Hardware Kit	Hardware Kit for 726640**
2	1	726676	Mount	AirSpring Base Mount
3	1	726571	Pivot	AirSpring Base Pivot
4	1	726674	Mount	AirSpring Head Mount
5	1	726684	Link	Stabilizer, White

Quantities are given per row

** See following table for details

Hardware Pack Components

ITEM	QTY	PART NUMBER	PART NAME	DESCRIPTION
6	1	13059	Bolt	5/16" X 1.5" GRD5 Bolt ZN
7	2	13107	Bolt	3/8" X 1.25" GRD5 Bolt ZN
8	2	13209	Bolt	1/2" X 1.5" GRD5 Bolt ZN
9	1	15214	Bolt	1/2" X 2.75" GRD8 Bolt ZN
10	2	33078	Washer	1/4" SAE Flat ZN CL
11	2	33086	Washer	1/2" SAE Flat ZN
12	1	36214	Hex Jam Nut	5/8" Hex Nut ZN CL
13	2	37260	Hex Nut	1/4" Top Lock ZN
14	1	37262	Hex Nut	5/16" Top Lock ZN
15	2	37264	Hex Nut	3/8" Top Lock ZN
16	3	37268	Hex Nut	1/2" Top Lock ZN
17	1	726112	Elbow	1/8"NPT X 1/4"PTC 90°
18	1	726115	Tee	1/4" PTC
19	2	726574	Bushing	1/4"ID X 1/2"OD X 0.23"L
20	2	726651	Bushing	3/8"ID X 5/8"OD X 0.40"L
21	1	879112	Bolt	5/16" X 0.88" GRD5 ZNY w/Nylon
22	2	24620Z	Low Head Bolt	1/4" X 1" Socket Bolt ZN
23	1	24635Z	Low Head Bolt	3/8" X 1" Socket Bolt ZN

Quantities are given per row

Recommended tools (not provided):

Open end wrenches: 7/16", 1/2", 9/16", 3/4", 15/16"

- &/or suitable crescent wrench (s)

Sockets (Deep well recommended): 7/16", 1/2", 9/16", 3/4", 15/16"

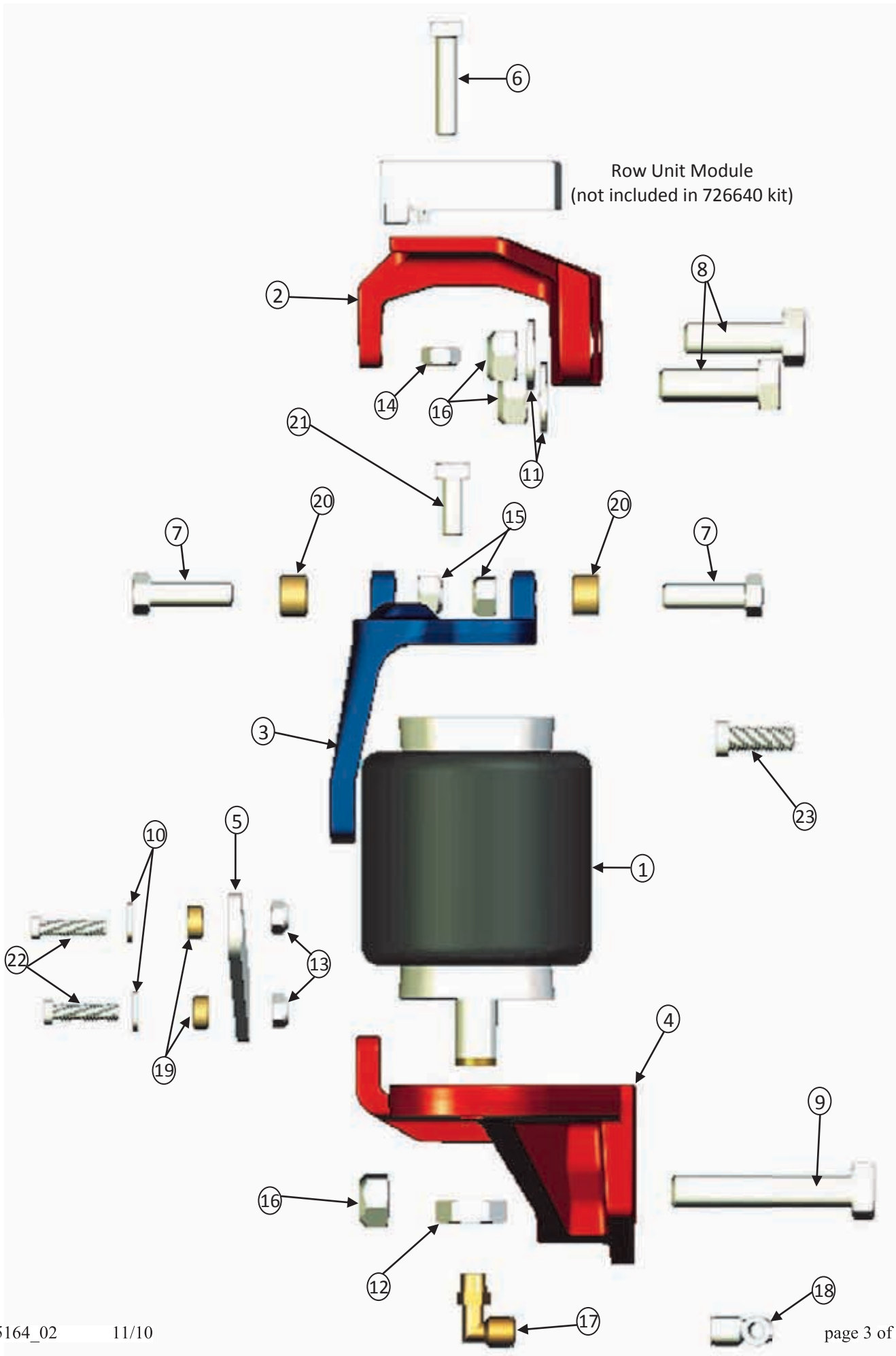

1. Begin installation by removing tension from the existing springs. For rows with a Row Unit Module installed, this will need to be removed prior to installation.

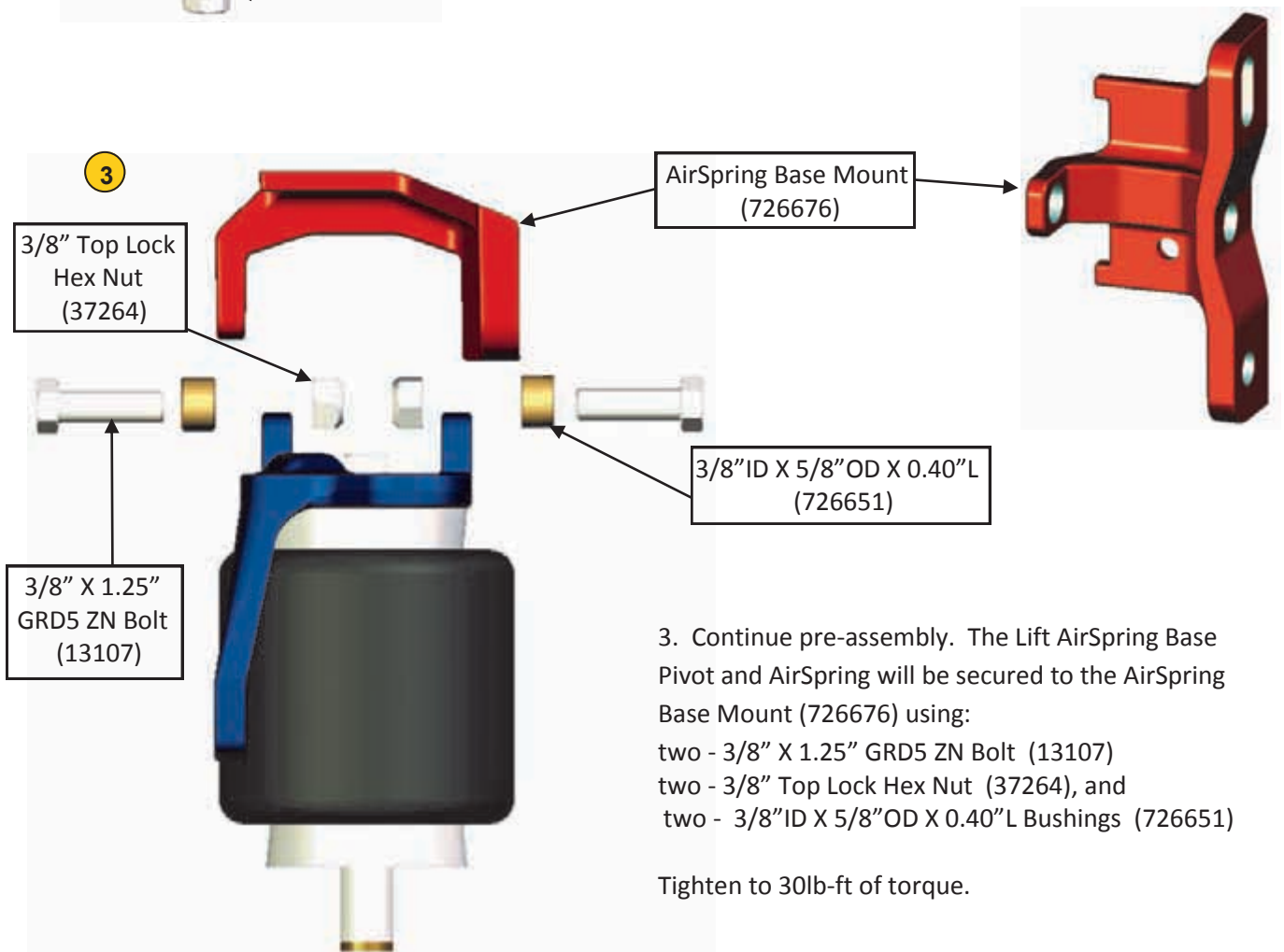
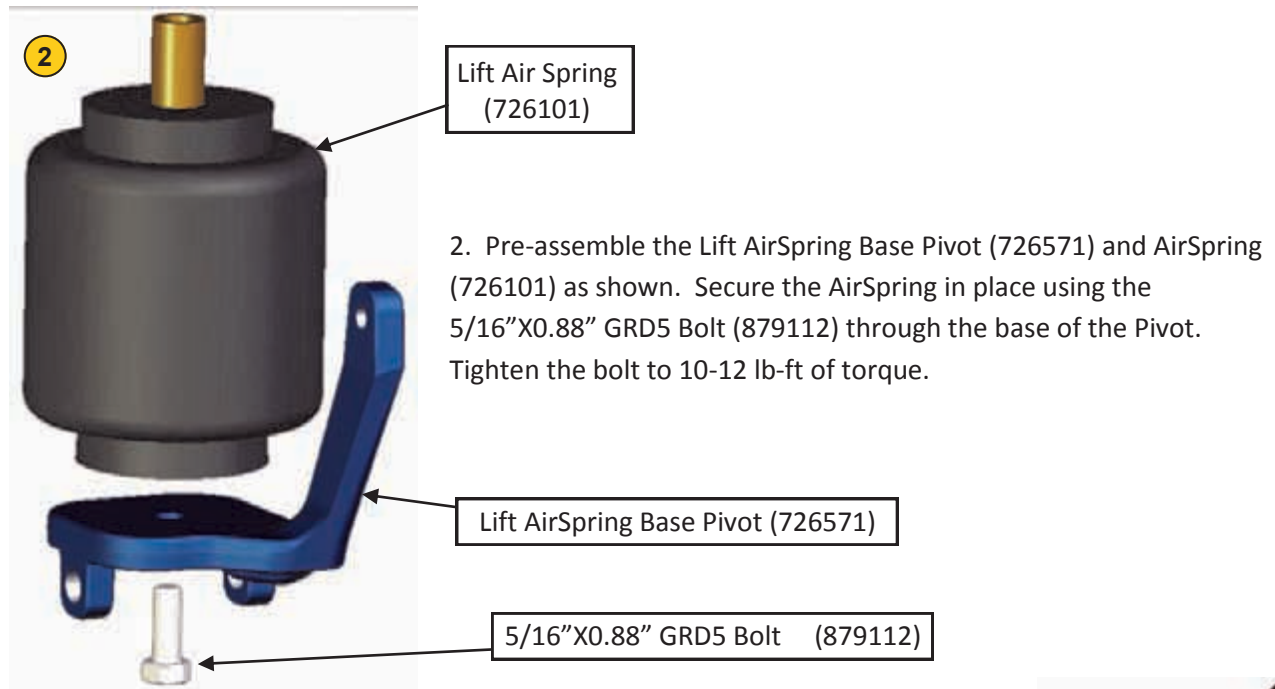

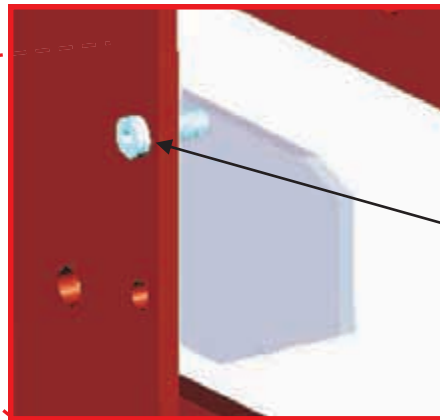
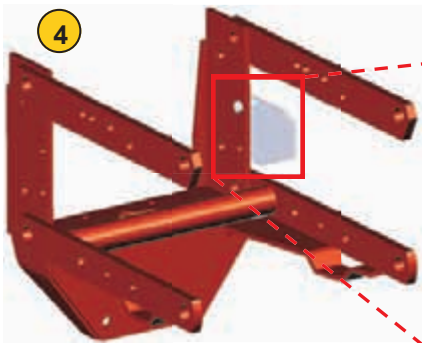

3/8" X 1"
Low Head Socket Bolt ZN
(24635Z)

4. Before installing new components on the row unit, replace the existing top bolt in the Stop Plate with the provided 3/8" X 1" Low Head Socket Bolt ZN (24635Z). This will increase clearance once the AirSpring has been installed and inflated. Tighten to 30lb-ft of torque.

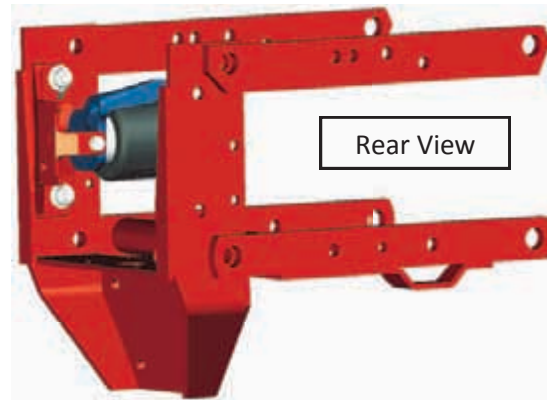
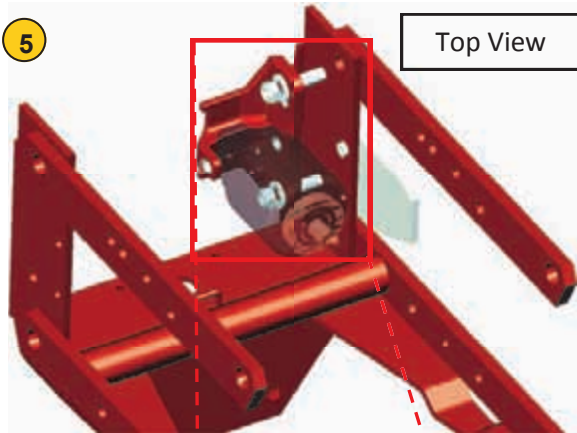

1/2" Top Lock Nut
(37268)

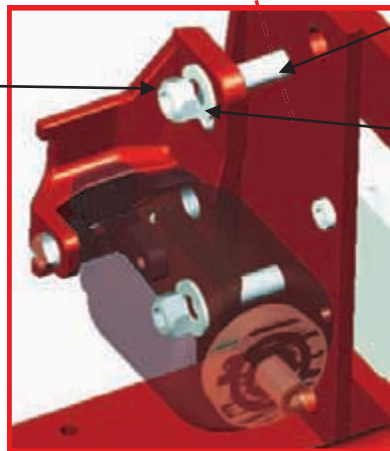

1/2" X 1.5" GRD5 Bolt ZN
(13209)

1/2" SAE Flat Washer
(33086)

5. Install the AirSpring, Pivot, and Base assembly, prepared earlier, to the Left-Rear vertical post of the row unit (when viewed from the rear of the row unit). Secure the assembly in place, as shown in the image at left, using:
two - 1/2" X 1.5" GRD5 Bolt ZN (13209)
two - 1/2" SAE Flat Washer (33086)
two - 1/2" Top Lock Nut (37268)

Tighten to 70lb-ft of torque.

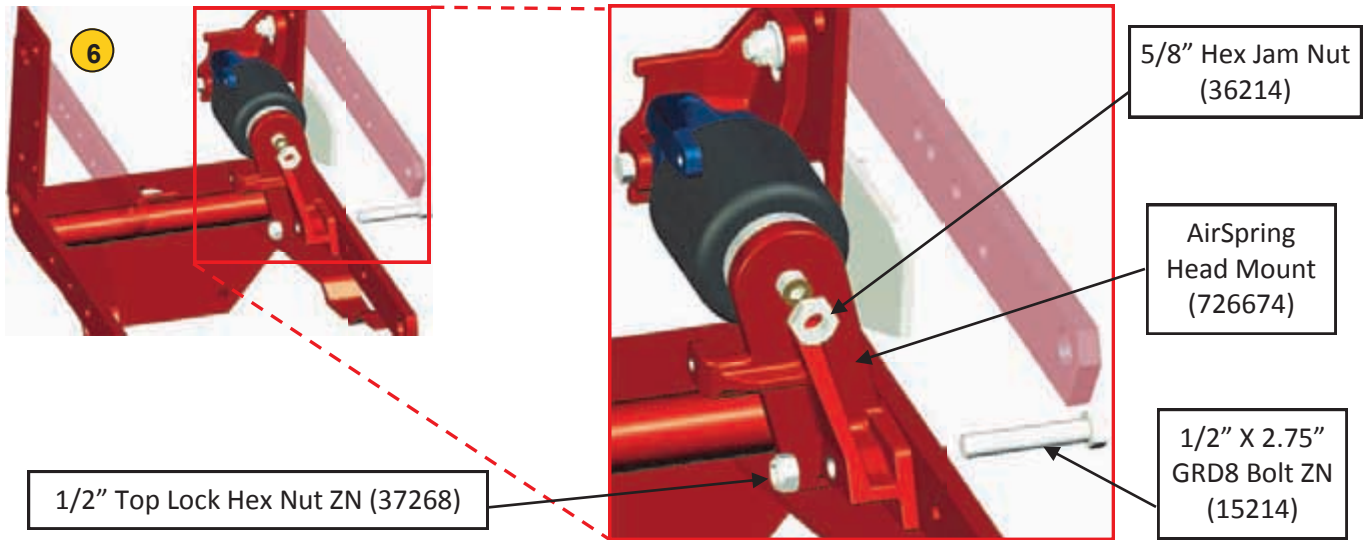

6. Next, secure the forward mounting bolt of the AirSpring to the LOWER-LEFT Parallel arm (when viewed from the rear of the row unit). To do this, install the AirSpring Head Mount (726674); to Lift AirSpring using the supplied 5/8" Hex Jam Nut (36214); and to the Parallel Arm using the supplied 1/2" X 2.75" GRD8 Bolt (15214) and 1/2" Top Lock Hex Nut (37268)

Tighten the Jam Nut to 10-12lb-ft of torque.

Tighten the bolt to 80-110lb-ft of torque

Please continue on to the next page.

7

1/4" SAE Flat Washer ZN (33078)

1/4" Top Lock Hex Nut (37260)

White Stabilizer Link (726684)

1/4"ID X 1/2"OD X 0.23"L
Bushing (726574)

1/4" X 1"
Low Head Socket Bolt
(24620Z)

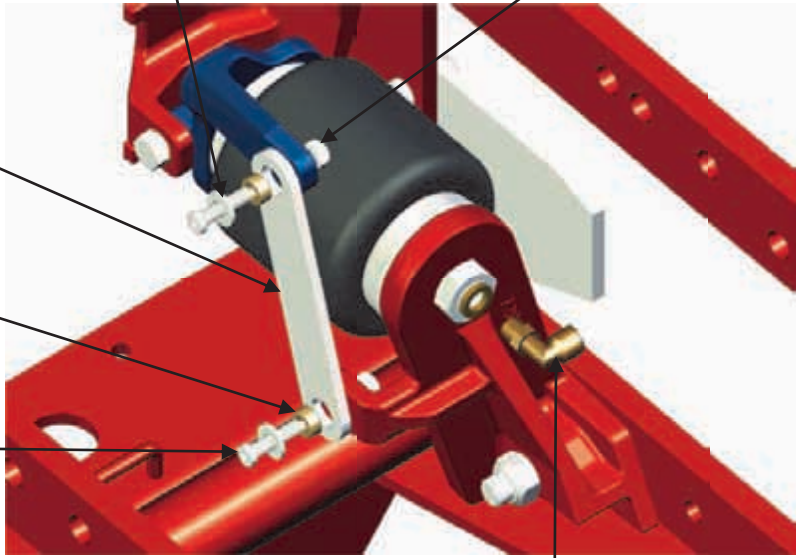

1/8" NPT X 1/4" PTC 90° (726112)

7. Next, connect the two cast component assemblies using White Stabilizer Link (726684). Secure both ends of the Link in place as shown using the supplied hardware:

- two - 1/4" X 1" Low Head Socket Bolt (24620Z)
- two - 1/4"ID X 1/2"OD X 0.23"L Bushing (726574)
- two - 1/4" SAE Flat Washer ZN (33078)
- two - 1/4" Top Lock Hex Nut (37260)

Tighten the 1/4" bolts to 8 lb-ft of torque.

Install the 1/8" NPT X 1/4" PTC 90° (726112) into the top of the AirSpring . Torque recommendation for this fitting is 'Hand tight plus 1 turn'.

8

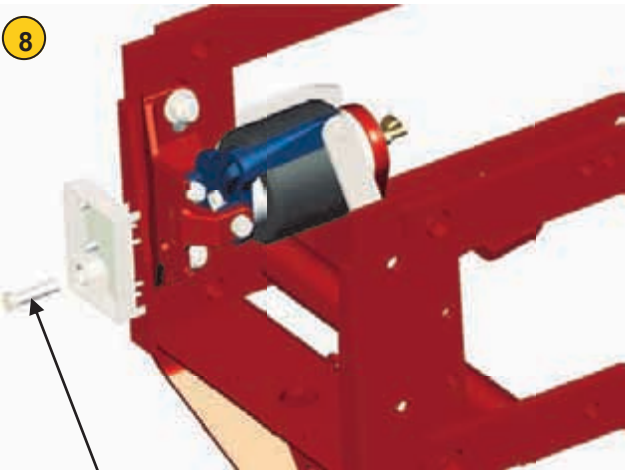

5/16" X 1.25" GRD5 Bolt ZN
(13059)

For row units with a Row Unit Module, this should be installed at the rear of the AirSpring Base Mount using the supplied 5/16" X 1.25" GRD5 Bolt ZN (13059).

9. Check tightness of all bolts and nuts, and freedom of motion/clearance of all components.

Completed Row Unit Conversion

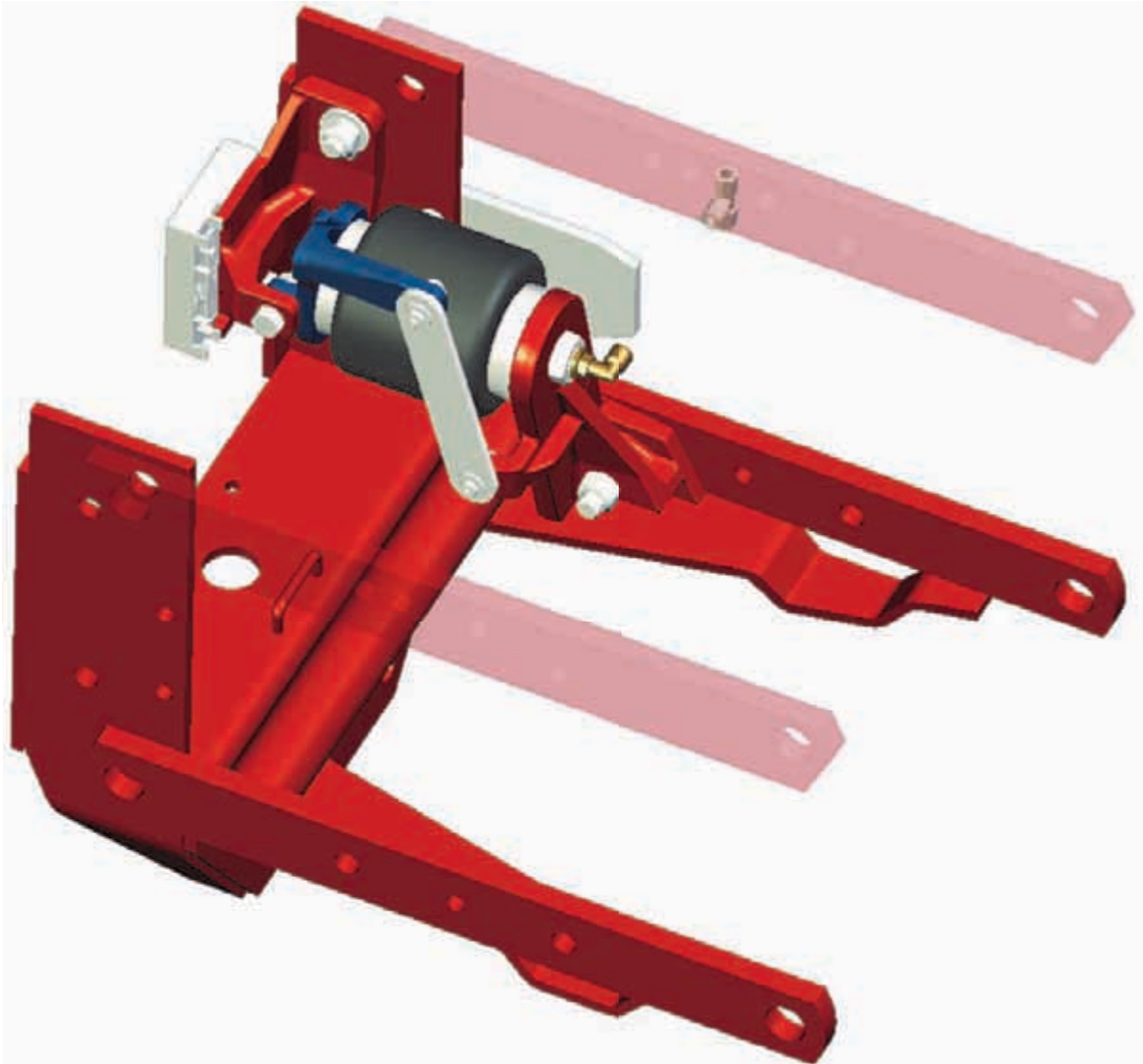

726640
White Lift AirForce