

Row Unit Conversion Instructions

for:

planter models:Great Plains YP series planters
to convert from **Existing Springs:**.....Great Plains Light & Heavy Duty Springs
to **Resulting Forces Controlled:**.....Lift Only
with **Conversion Kit:**.....726575

Existing Springs

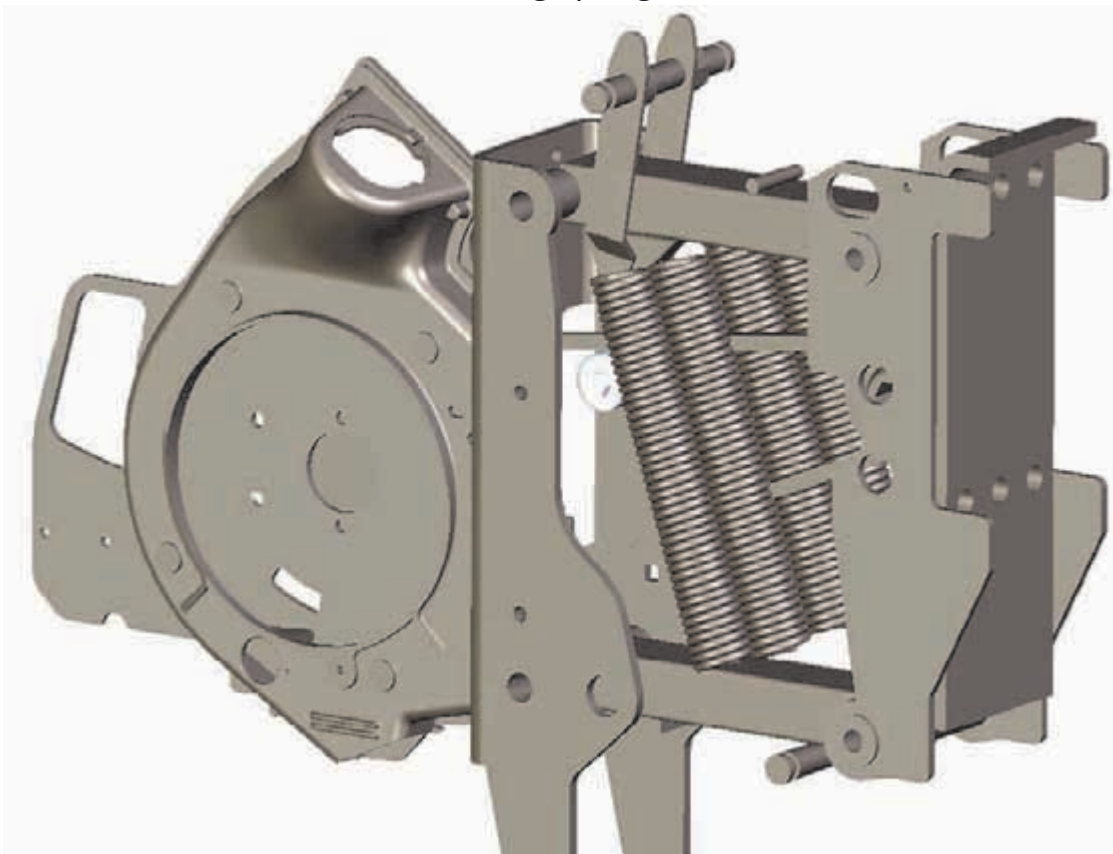

Illustrations of completed row unit and assembled components on last page.

Conversion Kit Components

QTY	PART NUMBER	PART NAME	DESCRIPTION
1	726101	Spring	Air Spring (Lift)
1	726589	Bracket	Lift Airspring Head Mount
1	726593	Bracket	Lift Airspring Base Mount
1	726594	Pivot	Lift Airspring Pivot Base
1	726597	Plate	Lift Airspring Link Plate
1	726607	Pack	Hardware Pack

Quantities are given per row

Hardware Pack Components

QTY	PART NUMBER	PART NAME	DESCRIPTION
1	13059	Bolt	5/16" X 1.5" GRD5 Bolt ZN
1	1317	Bolt	3/8" X 1.25" GRD5 Bolt ZN
2	15055	Bolt	5/16" X 1" GRD8 Bolt ZN
1	19915	Flange Bolt	5/16" X 5/8" Serrated Head ZNY
2	21818	Carriage Bolt	3/8" X 1.25" GRD5 ZN
2	33078	Washer	1/4" SAE Flat ZN
1	33080	Washer	5/16" SAE Flat ZN
1	36214	Hex Jam Nut	5/8" Hex Jam Nut ZN
3	37262	Hex Nut	5/16" Top Lock Nut ZN
7	37264	Hex Nut	3/8" Top Lock Nut ZN
1	726112	Elbow	1/8"NPT X 1/4" PTC Elbow
1	726115	Tee	1/4"PTC TEE
2	726522	U-Bolt	for 2" X 1.5" Tube
2	726532	Bushing	5/16"ID X 5/8"OD X 0.323"Length
2	726574	Bushing	1/4"ID X 1/2"OD X 0.23" Length
1	726596	Link	Airspring Base Stabilizer
1	726618	Spool	Great Plains Idler Spool
1	726619	Bushing	5/16"ID X 1/2"OD X 0.844"Length
1	726621	Collar Nut	3/8" UNC 5/8" Hex
2	13002N	Bolt	1/4" X 5/8" GRD5 Hex Bolt ZN w/ Nylon
1	13104N	Bolt	3/8" X 7/8" GRD5 Bolt ZN w/Nylon

Quantities are given per row

Recommended tools (not provided):

Open end wrenches: 7/16" 1/2", 9/16", 15/16"

- or suitable crescent wrench (s)

Sockets (Deep well recommended): 7/16", 1/2", 9/16", 5/8", 15/16"

Socket extension: ≥6" recommended

- 1 Begin installation by removing tension from the existing springs. Next, remove the hopper (if present) and meter from the row unit.

Continue by removing the Latch Plate the meter mounts to and removing the drive chain as well.

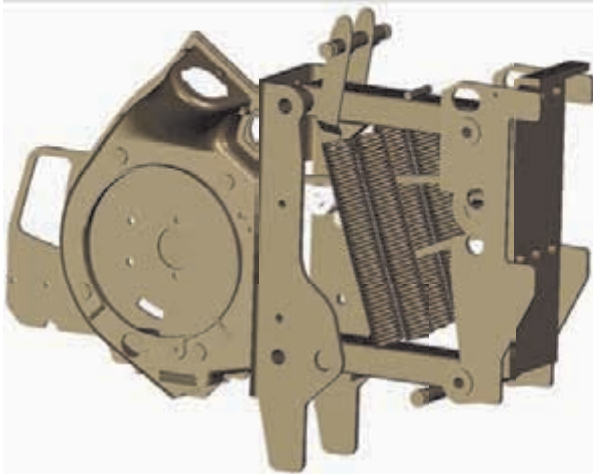

Standard Great Plains Row Unit

Complete the row unit preparations by dis-engaging and removing the existing springs. Raise the planter to remove the springs, then lower the planter until the parallel arms are level to continue the installation.

Set all components aside in an orderly fashion to assist reassembly.

Refer to the planter manufacturer's Owner's Manual for detailed instructions on the disassembly of these row unit components.

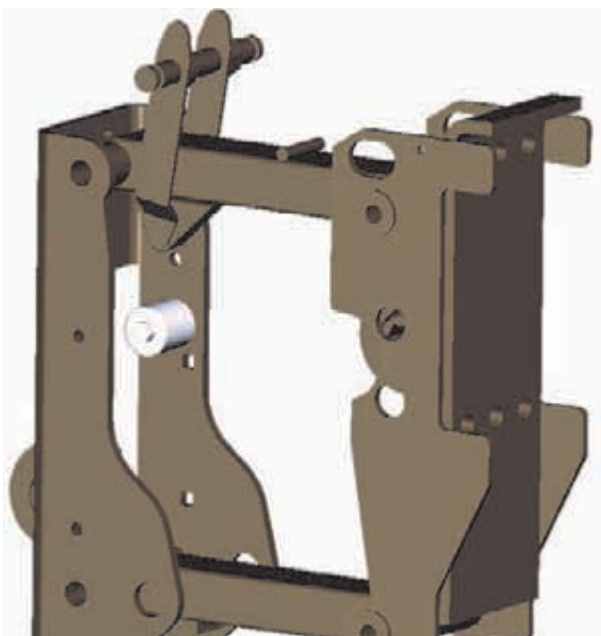

Row unit after completed Step 1; prepared for new component installation.

1

Assemble the Lift AirSpring Base Mount and Pivot brackets.
Refer to the illustration provided.
Note the orientation of the Base Mount bracket in relation to the Base Pivot bracket, as the Pivot arm will need to be aligned to the same side as the indent on the Base Mount.

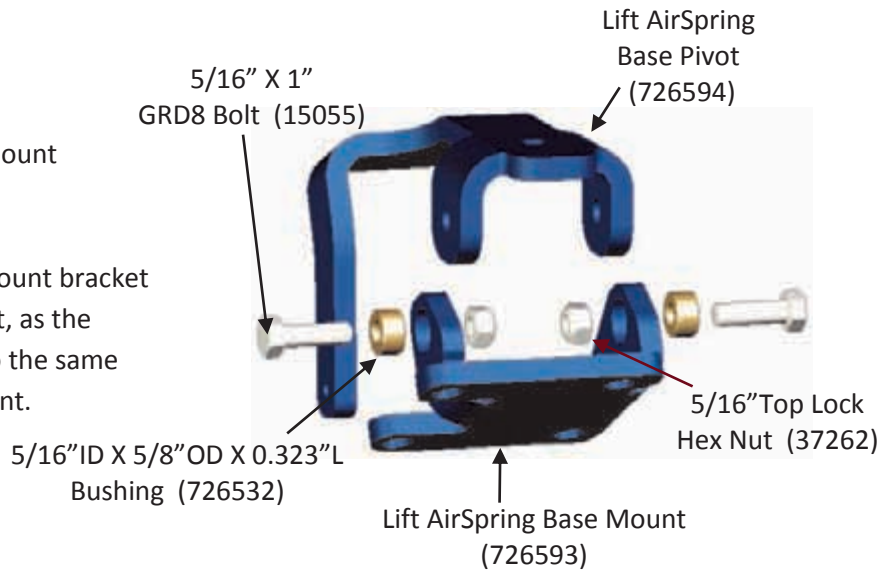

2

Position the Lift AirSpring Mounts assembly as shown in the illustration.

Secure the entire assembly in place using the supplied 2" X 1.5" U-Bolts (726522) and 3/8" Top Lock Hex Nuts (37264). It may be beneficial to install, but not tighten, the U-Bolts prior to aligning the assembly. Proper placement of the assembly places the U-bolts on either side of the stiffening plate, bottom side of lower parallel arm.

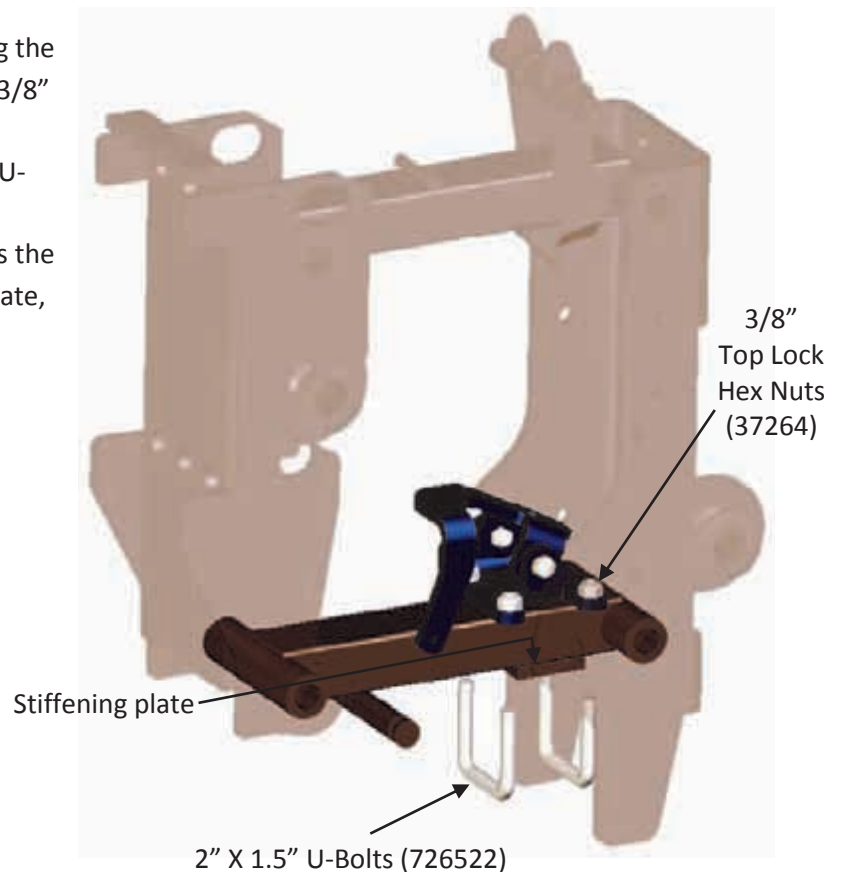

3

Continue the installation of new components with the assembly and placement of the Lift AirSpring Link-Plate (726597). Prior to mounting the Plate on the row unit, assemble the Great Plains Idler Spool and Base Stabilizer to the Plate.

Install the Idler assembly using:

- 5/16" X 1.5" GRD5 Bolt (13059)
- Great Plains Idler Spool (726618)
- 5/16" Top Lock Hex Nut (37262)

- 5/16" SAE Flat Washer (33080)
- 5/16" ID X 1/2" OD X 0.844"L Bushing (726619)

Install the Stabilizer Assembly using:

- AirSpring Base Stabilizer (726596)
- 1/4" SAE Flat Washer (33078)

- 1/4" ID X 1/2" OD X 0.844"L Bushing (726619)
- 1/4" X 5/8" GRD5 Bolt (13002N)

Once these components have been secured to the Link-Plate, fix the plate to the row unit using the 3/8" Carriage Bolts and Hex nuts.

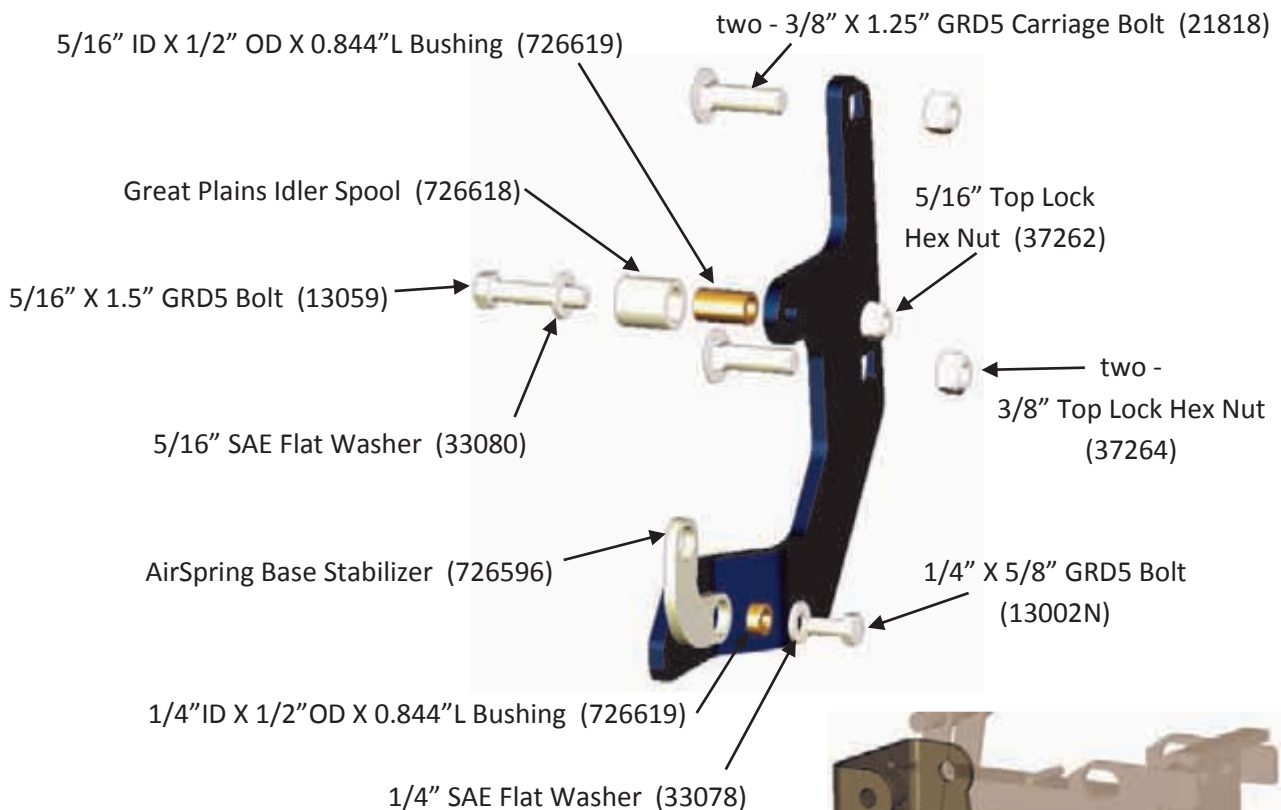
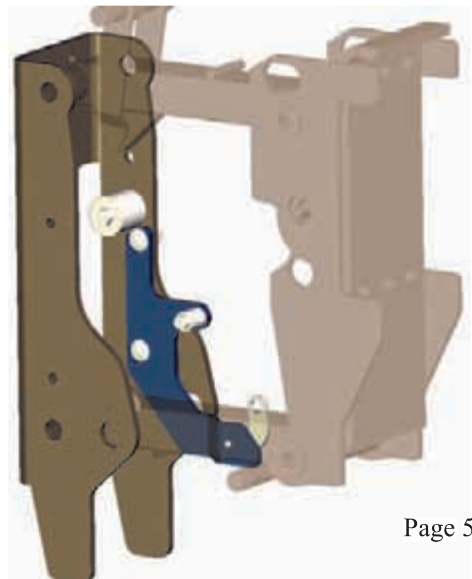

Illustration showing the Link-Plate as installed on the row unit.



4

Next, install the Lift AirSpring Head Mount bracket (726589) in the right rear corner of the row unit when standing behind the planter facing forward.

This will be done using the 3/8" X 7/8" GRD5 Hex Bolt w/nylon (13104N) and the 3/8" UNC 5/8" Hex Collar Nut (726621) installed parallel with the row unit. Note the two holes in the bracket for this bolt location. These are provided to line up with a variety of row units, use only one of these holes that correspond to your row unit.

Perpendicular to the row unit, fix the bracket in place using a 3/8" Top Lock Hex Nut (37264) and 3/8" X 1.25" GRD5 bolt (13107).

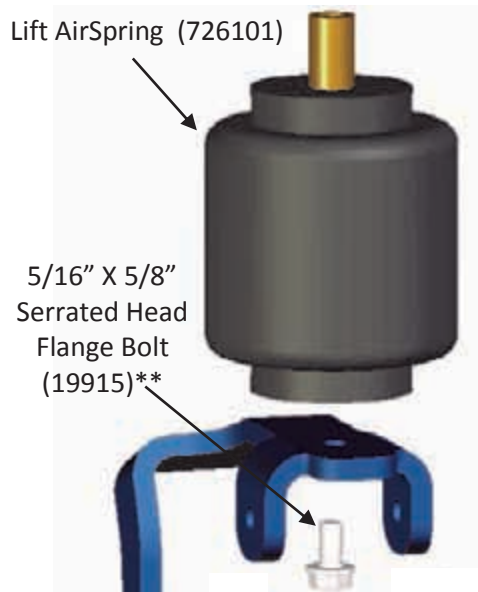
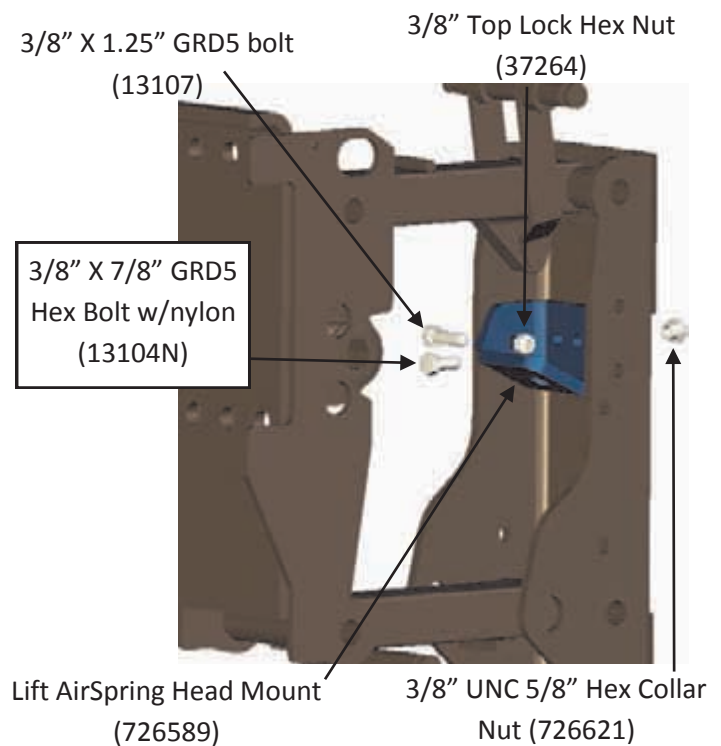

5

Route the brass fitting on the top of the air bag into the Lift AirSpring Head Mount. Adjust the assembly until the Base Mount is level and square against the lower parallel arm at the same time that the top surface of the air bag is squarely seated against the bottom surface of the Head Mount. This will require some manipulation of the bag to position it correctly.



**** Tighten the Flange Bolt into the base of the air bag to 10-12 lb-ft of torque.**

6

Fix the top of the assembly in place using the 5/8" Hex Jam Nut (36214).

Tighten the Jam Nut to 10-12 lb-ft of torque.

Install the 1/8"NPT X 1/4" PTC 90° Elbow (726112) into the top of the air bag fitting.

****Tighten the fitting to 'hand tight + 1 turn'.****

1/8"NPT X 1/4" PTC 90° Elbow (726112)

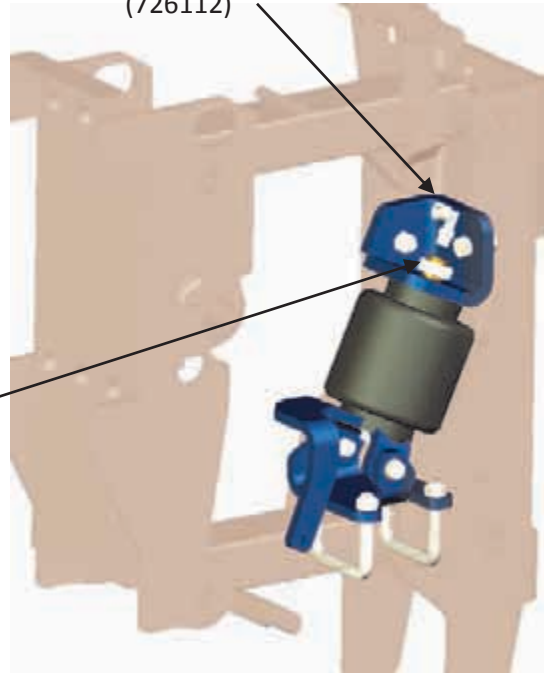

5/8" Hex Jam Nut (36214)

7

Complete the new component installation by fixing the forward arm of the Plate-Link to the lower arm of the Lift AirSpring Base Pivot.

Arrange the 1/4" SAE Flat Washer (33078) and the 1/4"ID X 1/2"OD X 0.23"L Bushing (726574) onto the 1/4" X 5/8" GRD5 Hex Bolt (13002N). Position this assembly in the AirSpring Base Stabilizer Link (726596) and thread the bolt into the lower arm of the Lift AirSpring Base Pivot.

Lift AirSpring Base Pivot - lower arm-

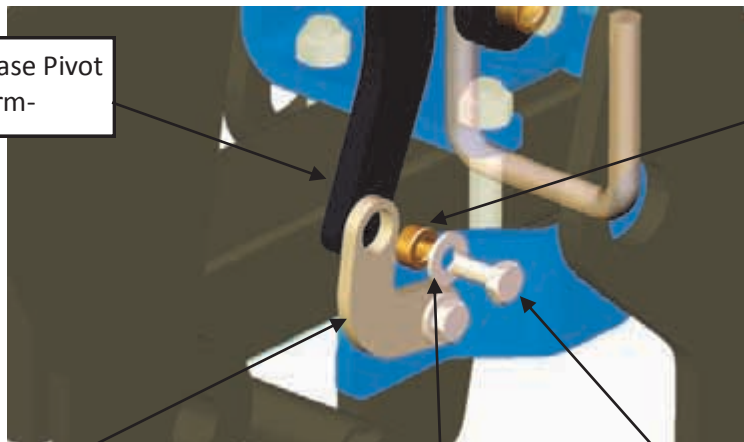

1/4"ID X 1/2"OD X 0.23"L Bushing (726574)

AirSpring Base Stabilizer Link (726596)

1/4" X 5/8" GRD5 Hex Bolt (13002N)

*Orient link with 'nose' facing forward

1/4" SAE Flat Washer (33078)



**Check tightness of all bolts and nuts.
Check freedom of motion/clearance of all components.**

Completed Row Unit Conversion

726575

Lift Only Control

Great Plains YP Series Planters

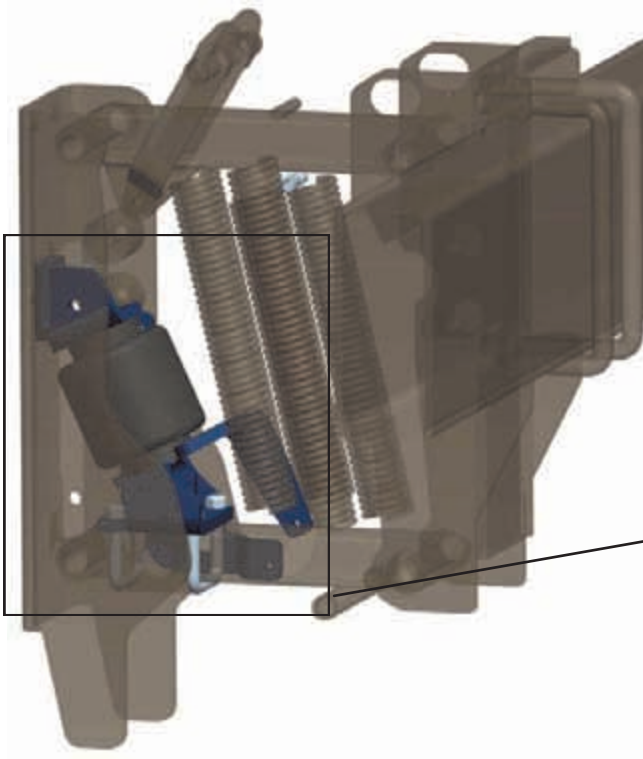

As viewed from the front Right

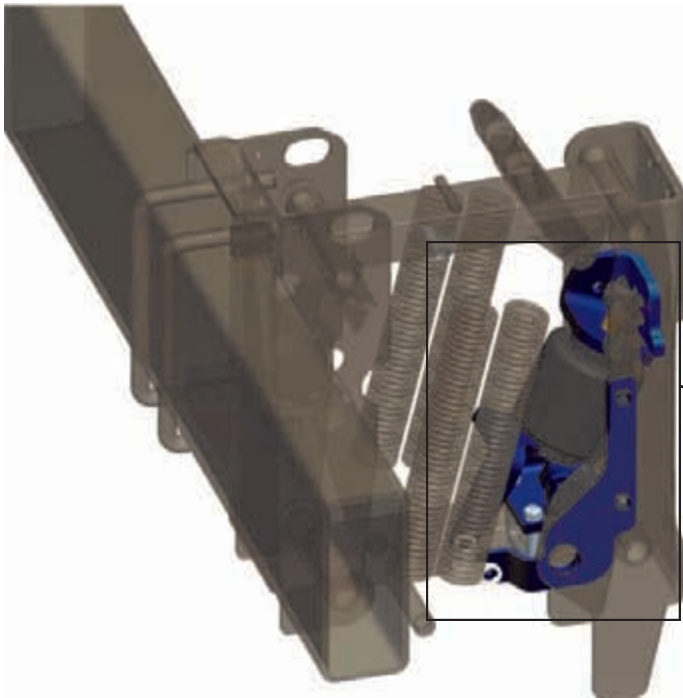

As viewed from the front Left

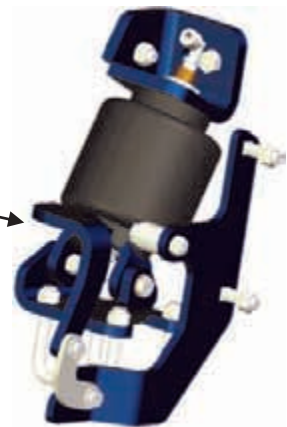

Supplemental Components - Ordered Separately

726623

**Row Unit Lock-Up
Great Plains YP Series Planters**

Row Unit Lock-Up Kit Components

QTY	PART NUMBER	PART NAME	DESCRIPTION
3	95226	Bolt	1/2" X 6.5" GRD5 Bolt ZNY
3	95864	Hex Nut	1/2" Hex Nut ZNY
6	96057	Washer	1/2" SAE Flat Washer ZNY
3	0123498	Lock Washer	1/2" Med. Split Lock Washer ZNY
1	726622	Plate	Great Plains Row Unit Lock-Up

Quantities are given per row

With the addition of AirForce to the row units, the traditional row unit lock-up mechanism will no longer be functional. This kit provides the means to still lock row units up.

Installation will require the replacement of three of the main bolts connecting the frame components to the parallel arms. The lower bolt hole of the Plate will be held in place when assembled as shown. The upper bolt hole of the Plate is a keyway that will be moved over the bolt heads, from forward to rear positions as required.

When in use the Lock-Up will be placed over the forward upper bolt head as shown.

When not in use, the plate can be held in the vertical position.

