

eSet 2003 JD Installation Modification

A Solution For 2003 Pro Series Planters with Metal Mounting Brackets

In 2003, Deere used a metal mounting bracket to mount the ProSeries Meter to the row unit. This bracket is not compatible with the ProFlow hopper, so customers needed to purchase the poly bracket from their Deere dealer. But there is an alternative to purchasing the poly bracket – just modify the metal bracket.

By drilling a couple of new holes in their metal bracket it is easy to use this bracket on the ProFlow Hopper. Just follow the directions outlined in the photos below.

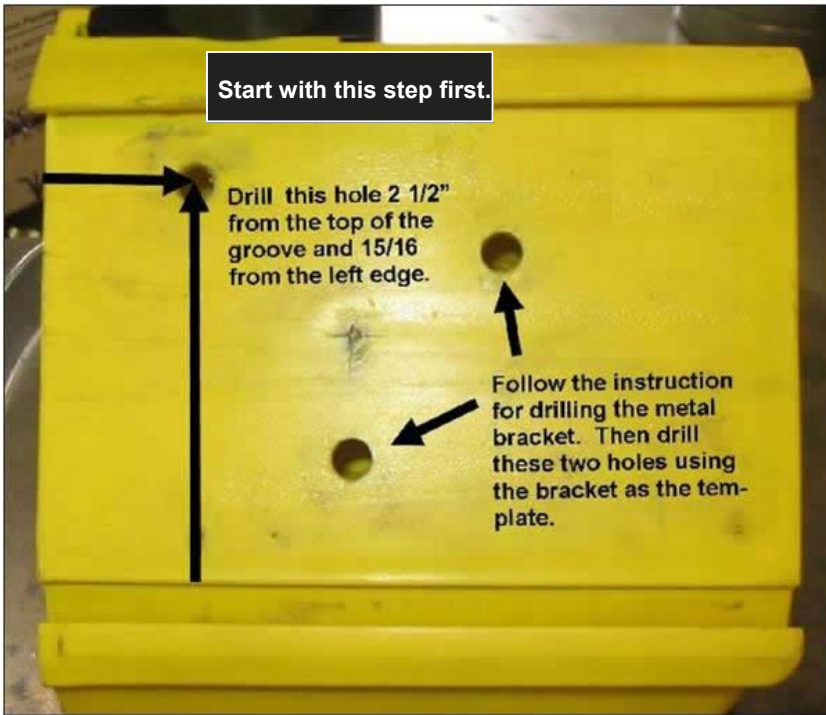

Start with the ProFlow Hopper and drill a hole in the upper left corner first. Next, drill the two new holes in the bracket as shown in the photo. Then mount the bracket to the hopper by inserting a bolt through the existing hole in the bracket and the new hole you drilled into the hopper. Align the bracket and hopper so the top of the bracket is parallel with the top lip of the hopper. Use a C clamp to secure the bracket to the hopper. Tighten the first bolt. Now use the two new holes on the bracket as a template to drill into the hopper. Once these holes are drilled, simply put the bolts through these new holes and tighten.

