



2010 System Selection Guide

Customer Name _____ Dealer Name _____ Dealer # _____

Customer Address _____ Cell Phone _____

Delivery Address _____

Planter Make _____ Model _____ Number of Rows _____ CCS _____ Pro Series _____

Step 1 – Identify your current downforce system: You will need to identify your current downforce system in order to select the correct compressor and airbag system. Refer to the illustrations and note the letter that identifies that style of row unit.



A: JD 7000 Light Duty
(2 spring/row)



B: JD HD 7000



C: JD HD 7000 95+



D: JD 7200/1700
(2 springs/row)



E: JD 7200/1700
Double Light Duty (4 springs/row)



F: JD 7200 Pre 92
4 HD Springs long arms



G: JD 7200 Pre 92
4 HD Springs reg. arms



H: JD 7200/1700
Dual Air Bags



I: 7200/1700/CNH/KZ
Single Air Bag



J: JD 7200/1700
HD Center Springs

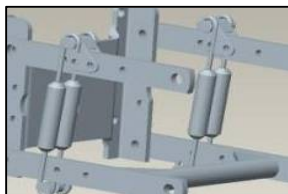

K: Kinze



L: JD HD 7200 95+

Parallel Arms Number of Rows of 14" _____ Number of Rows of 21" _____

Row Cleaner Make _____ Model _____ (see Row Cleaner Guide)

Step 2 – Select the Compressor: Select an Electric or Hydraulic Compressor System:

The pressure system will be:	Part # is:	Price
12 V compressor with Down and Lift Air Bags	726000	\$3,000
Hydraulic Compressor with Down and Lift Air Bags	726160	\$3,700

Step 3 – Bags and Brackets: Find the best description of your row unit configuration and indicate the quantity of rows that fit that description. Use the row cleaner compatibility chart to determine if you need a low (standard) or high lift bag bracket.

Planter Model	Existing DownPressure System	Drive System	Parallel Arms	Lift Bag Position	New Control System	The Part number	Price per row	Number of Rows
JD 7000/Kinze	Type A, B, K	Any	Regular	High	Lift Only	726025	\$140	
JD 7000	Type C	Any	Regular	High	Lift Only	726210	\$140	
JD 7200	Type D, G, E, L	Any	Regular	High	Lift Only	726040	\$140	
JD 7200	Type L, D, E	Any	Long	High	Lift Only	726045	\$140	
JD 1700 or 7200	HD Adjust. Center—Type J, D**, E**, G**, L**	Chain	Regular	Low	Down & Lift	726005	\$235	
JD 1700 or 7200	HD Adjust. Center—Type J, F	Chain	Long	Low	Down & Lift	726075	\$235	
JD 1700 or 7200	JD Pneumatic– Type I	Chain	Regular	Low	Down & Lift	726015	\$140	
JD 1700 or 7200	JD Pneumatic– Type I	Chain	Long	Low	Down & Lift	726030	\$140	
JD 1700 or 7200	HD Adjust. Center—Type J	Chain	Reg/Long	High*	Down & Lift	726315	\$235	
JD 1700 or 7200	JD Pneumatic– Type H, I	Any	Reg/Long	High*	Down & Lift	726325	\$140	
JD 1700	JD Pneumatic– Type I	Pro Shaft	Regular	Low	Down & Lift	726020	\$140	
JD 1700	JD Pneumatic – Type I	Pro Shaft	Long	Low	Down & Lift	726035	\$140	
JD 1700	HD Adjust. Center—Type J, D, E	Pro Shaft	Regular	Low	Down & Lift	726190	\$235	
JD 1700	HD Adjust. Center—Type J	Pro Shaft	Long	Low	Down & Lift	726195	\$235	
JD 1700	HD Adjust. Center—Type J	Pro Shaft	Reg/Long	None	Down Only	726200	\$145	
JD 1700	HD Adjust. Center—Type J	Pro Shaft	Reg/Long	High*	Down & Lift	726320	\$235	
2010 Style								
JD 7200					Down Only	726585	\$165	
JD 7200+					Lift/Conversion	726525	\$165	
JD 7200+					Down and Lift	726520	\$260	
Kinze					Lift	726540	\$165	
Kinze	Pusher Units				Lift	726550	\$165	
Great Plains					Lift	726575	\$165	

* This High Mount Bracket is not compatible with JD 1790 split row planters. JD 1780 and DB planters may require an additional adapter kit to reposition the meter vac tube (see accessories)

** Remove spring system and add down and lift system

Examples of AirForce Brackets

Low Bracket for 7200/1700
with Center HD Springs
(726005)

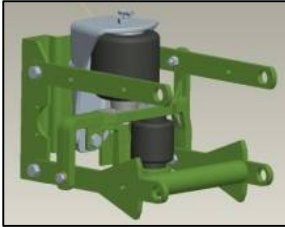

Low Bracket for 1700 with
JD Air Bags (726020)



High Bracket for KZ or 7000
with side springs (726025)

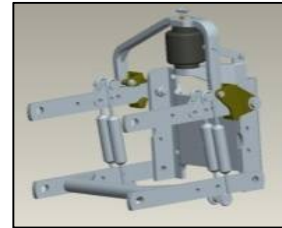

High Bracket for 1700
with JD Air Bags (726325)

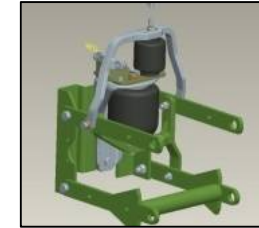

Step 4 – Air Lines and Fitting Kit: Select the part numbers you need to supply air from the compressor to the air bags.

- If you are using your current downforce air bag system, choose the appropriate part number from the Down System lists
- For systems with lift only, select the right system from the Lift System list.
- For systems that use both a lift bag and a downforce bag, select part numbers from the Down and Lift section to match your number of rows.
-

Lift System	# of Rows	Part Number	Price
Down Only	8	726275	\$80
	12-16	726280	\$160
	24	726285	\$240
	32 - 36	726290	\$360
	48 +	726295	\$480
Lift Only	8	726300	\$120
	12-16	726305	\$240
	24	726310	\$360
	32 - 36	726330	\$540
	48 +	726335	\$720
	52 +	726340	\$780
Down and Lift	8	726275 + 726300	\$200
	12-16	726280 + 726305	\$400
	24	726285 + 726310	\$600
	32 - 36	726290 + 726330	\$900
	48 +	726295 + 726335	\$1200

Step 5 – Lift Switch Kit: This Lift Switch locks the system when the system is lifted for waterways, turns or transport.

Planter	Parallel Arms	Part Number	Price
JD 1700/7200	Regular	726150	\$120
JD 1700/7200	Long	726260	\$120
JD 7000 or Kinze		726265	\$120

Step 6 – Optional Compressor and Tank Mounting Hardware Kit: Various mount kits are available. Select one of these kits or build your own.

Description	Applicable Models	Bar size (w×h)	Part Number	Price
John Deere				
Drawn, rigid tongue	JD 7000, 7200	5 x 7	726055	\$55
Drawn, folding tongue 20' or less 1780, all 7240	JD 7000/7200	N/A – 3/8 bolts	726059	\$5
	JD 7240, 1750			
	JD 1780 – 20' wide or less			
30' front fold Deere except 1770NT	JD 7000, 7200, 1700	3 x 8	726052	\$55
40'/60' front fold Deere , all 1770NT	JD 7000, 7200, 1700	3 x 5	726050	\$55
Wing fold	JD 1760	8 x 10	726057	\$55
4 x 6 Draft Tube DB 90	JD 1780 – 30' wide or more	4 x 6	726053	\$55
	JD DB 90			
3 x 6 Draft Tube (DB 80' and less)	JD DB	3 x 6	726051	\$55
3 pt Vertical fold or rigid frame	JD 7300/1720/1710	7 x 7	726056	\$100
Stack fold (7x4 w/ spacer) center bar	JD 7300/1720	7 x 4	726500	\$100
7 x 7 Mounts to front of bar	7100/7300/1700/1710//1720	7 x 7	726060	\$125
Front fold models. High mount	Mounts to draft tube		726470	\$85
Hydraulic Compressor – rear center frame	1770NT/1790//DB	8 x 12 U-bolts	726490	\$85
Mount to crossbar on 3-pt hitch	7000/7200/1770/1770NT/1790		726515	\$125
JD Custom Mount Kit		3x3 - 8x12 tube	726450	\$100

Step 6 – Optional Compressor and Tank Mounting Hardware Kit (Continued)

Description	Applicable Models	Bar size (w×h)	Part #	Price
Kinze				
Kinze Rear Fold	Kinze Rear Fold	4 x 4 U-bolts	726397	\$55
2 tube tongue	Kinze 2000/3000	J Bolts	726398	\$125
Rigid or Vert fold – mounts over bar	2100/3100/2300/2400/2500/3400/3500	7 x 7 w/ spacer	726056	\$100
7 x 7 Mounts to front of bar	Kinze 2140/3140	7 x 7	726060	\$125
Kinze Wing Fold	Kinze 2200/3200	4 x 7	726054	\$65
Kinze Twinline	Kinze 2300, 2500/2600 & 35/3600	8 x 8 w/ spacer	726058	\$125
16 Row Mounts to tongue	Kinze 2600/3600	10x10 w/spacer	726455	\$125
Side mount brackets	Kinze 2700/3700		726435	\$125
Kinze 3pt w/ finger meter	Kinze 2100		726056	\$55
Side mount brackets	Kinze 3800	7 x 7	726060	\$125
“Universal” Mounting Kit	Includes components to create a kit		726450	\$125

Step 7 – Options and Additional Items required for some systems:

Accessory	Price	Part Number	Quantity
Smart Pin and RUM kit – 2 5/8” pins and 2 RUMS	\$500	726375	
Smart Pin and RUM kit – 2 1/2” pins and 2 RUMS	\$500	726380	
Smart Link and RUM kit – 2 Kinze 3000 links and 2 RUMS	\$500	726385	
Smart Link and RUM kit – 2 White links and 2 RUMS (8000 Series)	\$500	726390	
Smart Link and RUM kit – 2 CNH load cell and 2 RUMS	\$500	726395	
12’ Compressor Power Extension Cable	\$140	726224	
Control Conversion Kit – converts from down only to down and lift system	\$225	726365	
Control Conversion Kit – converts from lift only to down and lift system	\$225	726370	
Vac tube adapter kit for 1780 front fold with high bracket (one per planter)	\$432	726368	
Vac Tube Adapter kit for DB- order 1 per rear row & 1 per front fold section	\$40	726369	
Hydraulic Hose Kit for JD 1790/70 planters – “T” into CCS Circuit	\$180	726400	
Hydraulic Hose Kit for JD DB planters – “T” into CCS Circuit	\$180	726405	
Hydraulic Hose and Coupler Kit for planters w/ Hyd Comp. – separate circuit	\$180	726410	
TruCount Pressure Regulator	\$70	726420	
2008 20/20 to SeedStar 4-pin adapter cable	\$10	725440	
Stop Kit for 1770NT planters	\$35	726478	
Set back brackets - JD 7000 front fold w/ type “A” or “C” springs (6)	\$80	726480	
Set back brackets - JD 7000 front fold w/ type “B” springs (6)	\$75	2975-188	
Set back brackets - JD 1720 w/ wing drive and high AF (4)	\$75	2975-189	
Set back brackets - Kinze 2700, 3700 (3 – 4 if 20” rows)	\$80	726480	

Set back brackets - Kinze 3400 (12)	\$80	726480	
-------------------------------------	------	--------	--